

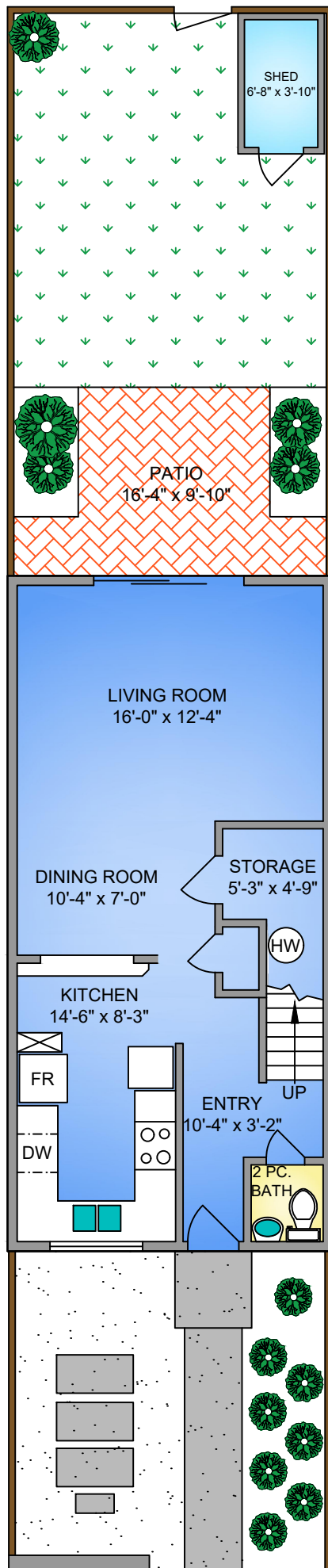

MAIN FLOOR
576 SQ. FT.
8'-0" CEILING

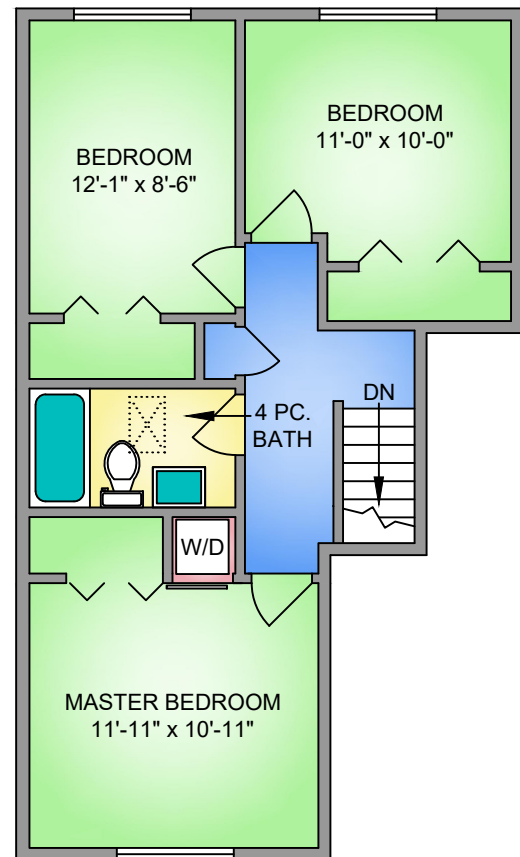

UPPER FLOOR
578 SQ. FT.
8'-0" CEILING



NORTH

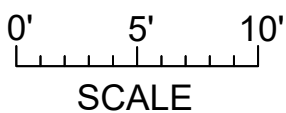
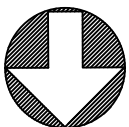

UNIT 15 - 10145 THIRD STREET AUGUST 12, 2019		
PREPARED FOR THE EXCLUSIVE USE OF MICHELE HOLMES PLANS MAY NOT BE 100% ACCURATE, IF CRITICAL BUYER TO VERIFY.		
FLOOR	AREA (SQ. FT.)	
	FINISHED	PATIO
MAIN	576	118
UPPER	578	-
TOTAL	1144	118