

THIRD FLOOR
447 SQ. FT.

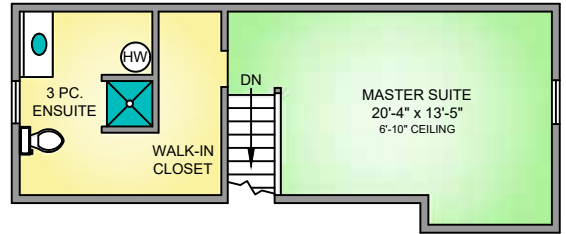

SECOND FLOOR
972 SQ. FT.

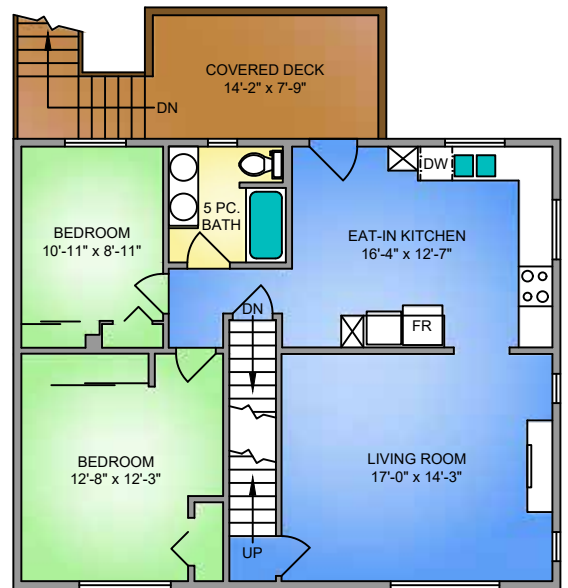

FIRST FLOOR
1165 SQ. FT.

NORTH

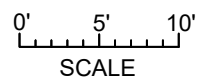
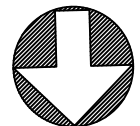

2313 BRADFORD AVENUE
JANUARY 30, 2019
PREPARED FOR THE EXCLUSIVE USE OF MICHELE HOLMES
PLANS MAY NOT BE 100% ACCURATE, IF CRITICAL BUYER TO VERIFY.
ORIGINALLY MEASURED ON 13/11/15

FLOOR	AREA (SQ. FT.)		
	FINISHED	GARAGE	DECK / PATIO
FIRST	1165	580	800
SECOND	972	0	110
THIRD	447	0	0
TOTAL	2584	580	910



250-884-9753
matt@propermeasure.com
www.propermeasure.com



HOLMES
(REALTY)